



Twisted Rainbow using the View & Do Circle Shape

Finished size 81" x 97"

Follow the chart for 48 bull's-eyes.

- Black Borders 1 yd cut into 6 inch strips
- Outside Borders 2/3 yd cut into 2 inch strips
- Batting 85x105 inches
- Backing 85x105 inches
- Binding 2/3 yd

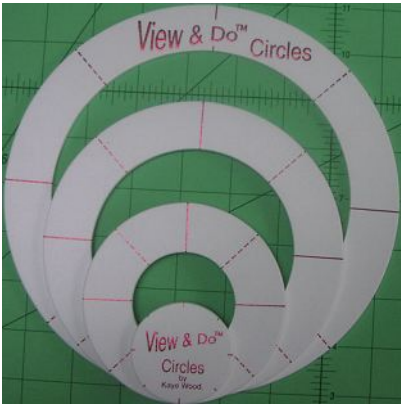

Bull's-eye Technique #2, #3 and #4 Finished Edge Circles



Finished Edge: Yardages for Faced, Turned-Under and Lined Circles						
Finished Size	# bull's-eyes	# quarters	12" squares 3 per strip	8" circles** 4 per strip	6" circles** 6 per strip	4" circles** 9 per strip
	1	4	12 x 12"	8-1/2 x 8-1/2"	6-1/2 x 6-1/2"	4-1/2 x 4-1/2"
	2	8	1/3 yd	1/4 yd	6-1/2 x 13"	4-1/2 x 9"
	3	12	1/3 yd	1/4 yd	6-1/2 x 21"	4-1/2 x 14"
	4	16	2/3 yd	1/4 yd	6-1/2" strip*	4-1/2 x 20"
	5	20	2/3 yd	1/4 yd	6-1/2" strip*	4-1/2 x 24"
	6	24	2/3 yd	1/2 yd	6-1/2" strip*	4-1/2 x 28"
	8	32	1 yd	1/2 yd	1/2 yd	4-1/2" strip*
	16	64	2 yds	1 yd	2/3 yd	1/4 yd
Crib (45 x 60")	20	80	2-1/3 yds	1 yd	2/3 yd	1/3 yd
	24	96	3 yds	1-1/2 yds	1 yd	1/2 yd
Twin (72 x 90")	48	192	5-1/3 yds	2-2/3 yds	1-1/2 yds	3/4 yd
Full (80 x 95")	56	224	6-1/2 yds	3 yds	2 yds	1-1/2 yds
Queen (90 x 105")	72	288	8 yds	4 yds	2-1/2 yds	2 yds

Bull's-eye Technique #1 Fray-Away (Raw Edge) Applique



Yardages for Fray-Away Applique						
Finished Size	# bull's-eyes	# quarters	12" squares 3 per strip	8" circles 5 per strip	6" circles 7 per strip	4" circles 10 per strip
	1	4	12 x 12 inches	8 x 8 inches	6 x 6"	4 x 4"
	2	8	1/3 yd	1/4 yd	6 x 12"	4 x 8"
	3	12	1/3 yd	1/4 yd	6 x 18"	4 x 12"
	4	16	2/3 yd	1/4 yd	6" strip*	4 x 16"
	5	20	2/3 yd	1/4 yd	6" strip*	4 x 20"
	6	24	2/3 yd	1/2 yd	6" strip*	4 x 24"
	8	32	1 yd	1/2 yd	1/3 yd	4" strip*
	16	64	2 yds	1 yd	1/2 yd	1/4 yd
Crib (45x60 inches)	20	80	2-1/3 yd	1 yd	1/2 yd	1/4 yd
	24	96	3 yds	1-1/4 yds	1 yd	1/2 yd
Twin (72x90 inches)	48	192	5-1/3 yd	2-1/2 yds	1-1/3 yd	2/3 yd
Full (80x95 inches)	56	224	6-1/2 yds	2-2/3 yd	1-1/3 yd	1 yd
Queen (90x105 inches)	72	288	8 yds	3-1/2 yds	2 yds	1 yd

*Strips are all 42-44" long (the width of the fabric)



Technique #2 Faced Applique

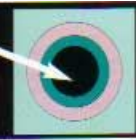

Background Squares

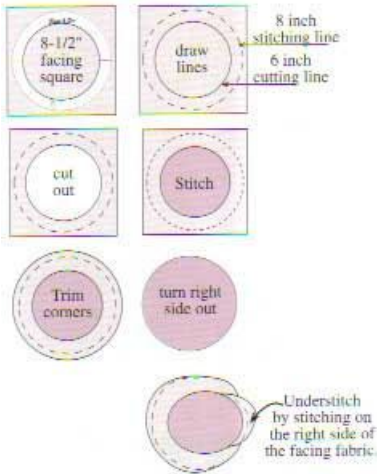
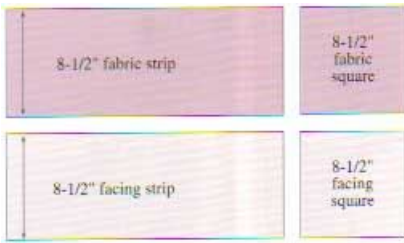

1. Cut 12 inch strips.

- 3 squares per 42/44" strip; for example, for 15 bull's-eyes, cut 5 strips.

Cut 12 inch strips into 12 inch squares. Cut one square for each bull's-eye.

8 inch circles

2. Cut 8-1/2 inch strips.

- 4 squares per 42/44 inch strip; for example, for 15 bull's-eyes, cut 4 strips.

Cut 8-1/2 inch strips into 8-1/2 inch squares. Cut two squares for each bull's-eye; one for the top and one for the facing.

3. Center the 8 inch [View & Do Circle Shape](#) on the wrong side of each of the 8-1/2 inch facing squares. Draw around the outside and inside of the 8 inch [View & Do Circle Shape](#) with a fabric pencil: the outside circle line is the stitching line; the inside line is the cutting line. Cut out the circle following the inside (smaller) circle line.

Place a facing square right sides together with a fabric square, with the facing square on top. Pin in place. Stitch around the entire circle following the stitching line on the facing square. Trim the corners of the squares 1/4 inch from the sewing line.

Understitch the facing (optional).

Place the faced circle, with the wrong side of the facing up, under the foot of the sewing machine. Move the circle over so the needle will stitch just past the seamline on the right side of the facing and through both seam allowances.

No stitching will show on the fabric circle. Understitching gives the circle a smoother curved edge and it pulls the facing toward the back of the fabric circle.

Turn the circle right side out. Press.

6 inch circles

4. Cut 6-1/2 inch strips.

- 6 squares per 42/44 inch strip; for example, for 15 bull's-eyes, cut 3 strips.

Cut 6-1/2 inch strips into 6-1/2 inch squares. Cut two squares for each bull's-eye; one for the top and one for the facing.

5. Center the 6 inch [View & Do Circle Shape](#) on the wrong side of each of the 6-1/2 inch facing squares. Draw around the outside and inside of the 6 inch [View & Do Circle Shape](#) with a fabric pencil: the outside circle line is the stitching line; the inside line is the cutting line. Cut out the circle following the inside (smaller) circle line.

Place a facing square right sides together with a fabric square, with the facing square on top. Pin in place. Stitch around the entire circle following the stitching line on the facing square. Trim the corners of the squares 1/4 inch from the sewing line.

Understitch the facing; stitch through the facing and both seam allowances close to the seamline. Turn the circle right side out. Press.

4 inch circles

6. Cut 4-1/2 inch strips.

- 9 squares per 42/44 inch strip; for example for 15 bull's eyes, cut 2 strips.

Cut 4-1/2 inch strips into 4-1/2 inch squares. Cut two squares for each bull's-eye; one for the top and one for the facing.

7. Center the 4 inch [View & Do Circle Shape](#) on the wrong side of each of the 4-1/2 inch facing squares. Draw around the outside and inside of the 4 inch [View & Do Circle Shape](#) with a fabric pencil: the outside circle line is the stitching line; the inside line is the cutting line. Cut out the circle following the inside (smaller) circle line.

Place a facing square right sides together with a fabric square, with the facing square on top. Pin in place. Stitch around the entire circle following the stitching line on the facing square. Trim the corners of the squares 1/4 inch from the sewing line.

Understitch the facing; stitch through the facing and both seam allowances close to the seamline. Turn the circles right side out. Press.

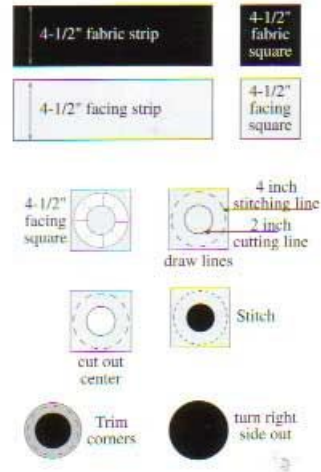
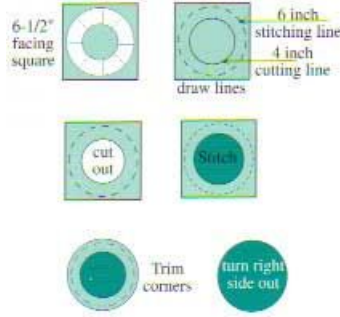

Technique #3 Turned-Under Applique

Turned-Under Applique

The edges of the circles are sewn to a light weight stabilizer, such as [Sulky Cut-Away Soft 'n Sheer](#) (one package is enough for 4 complete bull's-eyes). When turned right side out, the circles will have a nice smooth curve without the added weight of a fabric facing.

Background squares

1. Cut 12 inch strips.

- 3 squares per 42/44 inch strip; for example, for 15 bull's-eyes, cut 5 strips.

Cut 12 inch strips into 12 inch squares. Cut one square for each bull's-eye.

8 inch circles

2. Cut 8-1/2 inch strips.

- 4 squares per 42/44 inch strip; for example, for 15 bull's-eyes, cut 4 strips.

Cut 8-1/2 inch strips into 8-1/2 inch squares. Cut one fabric square and one stabilizer square for each bull's-eye.

3. On each 8-1/2 inch stabilizer square, draw around the outside and inside of the 8 inch [View & Do Circle Shape](#) with a fabric pencil; the outside circle line is the stitching line; the inside line is the cutting line.

Do not cut out the inside circle at this time. The stabilizer is very thin and will hold its shape better with the stabilizer in one solid piece.

4. Center an 8-1/2 inch stabilizer square on the right side of an 8-1/2 inch fabric square. Pin in place. Stitch around the entire circle following the stitching line on the stabilizer.

Trim the corners of the squares 1/4 inch from the sewing line.

Cut out the inside circle on the stabilizer. Turn the circle right side out. Press.

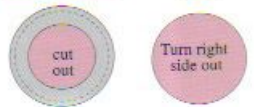
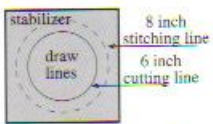
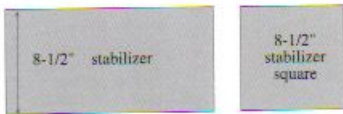

6 inch circles

5. Cut 6-1/2 inch strips.

- 6 squares per 42/44 inch strip; for example, for 15 bull's-eyes, cut 3 strips.

Cut 6-1/2 inch strips into 6-1/2 inch squares. Cut one square for each bull's-eye.

6. On each 6-1/2 inch stabilizer square, draw around the outside and inside of the 6 inch [View & Do Circle Shape](#) - the outside circle line is the stitching line; the inside line is the cutting line.

7. Center a 6-1/2 inch stabilizer square on the right side of a 6-1/2 inch fabric square. Pin in place. Stitch around the entire circle following the stitching line on the stabilizer. Trim the corners of the squares 1/4 inch from the sewing line.

Cut out the inside circle on the stabilizer. Turn the circle right side out. Press.

4 inch circles

8. Cut 4-1/2 inch strips.

- 9 squares per 42/44 inch strip; for example, for 15 bull's-eyes, cut 2 strips.

Cut 4-1/2 inch strips into 4-1/2 inch squares. Cut one square for each bull's-eye.

9. On each 4-1/2 inch stabilizer square, draw around the outside and inside of the 4 inch [View & Do Circle Shape](#) - the outside circle line is the stitching line, the inside line is the cutting line.

10. Center a 4-1/2 inch stabilizer square on the right side of a 4-1/2 inch fabric square. Pin in place. Stitch around the entire circle following the stitching line on the stabilizer. Trim the corners of the squares 1/4 inch from the sewing line.

Cut out the inside circle on the stabilizer. Turn the circle right side out. Press.

When layering the circles stitch around each circle using a narrow zigzag, applique or blanket stitch. Use matching thread and stitch close to the edge of the circle.

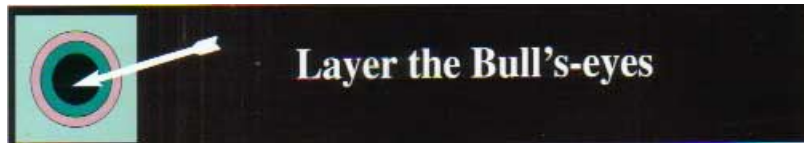
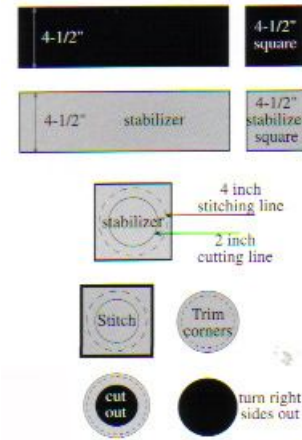
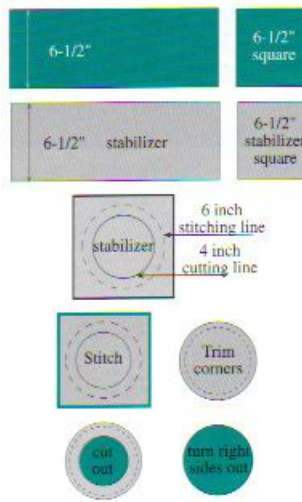

Background Squares

1. Fold the background squares in half, right sides out. Fold in half again. Press creases with an iron.

- Three creases will be facing up; one crease will be facing down.

8 inch circles

2. Fold the 8 inch circles in half, right side out; fold in half again. Press creases with an iron.

3. Center the 8 inch fabric circle on top of the square by matching crease lines.

- Creases should match the creases on the background square - 3 creases facing up; one facing down.

4. Pin the circle in place or use a spray fabric adhesive to temporarily bond the circle to the square.

5. Stitch the circle:

Fray-Away Applique

- Topstitch 1/4 inch from the edge of the circle for a little bit of fraying.
- Topstitch up to 3/4 inch from the edge of the circle for more fraying.

Faced Applique

- Topstitch 1/2 inch from the edge of the circle.

Turned-Under Applique

- Stitch part on and part off the edge of the circle with a narrow zigzag or blanket stitch. Use matching thread.

6. To trim or not to trim -

- Trim: to reduce bulk, cut the background fabric from behind each circle, 1/2 inch from the stitching line.

This cut out piece can be recut into a 6 inch or 4 inch circle.

The layering technique is the same for Fray-Away, Faced or Turned-Under edges.

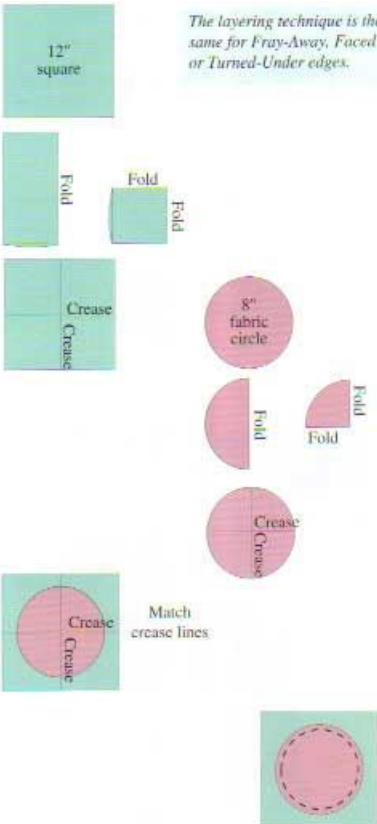

- Not trim: For greater strength, especially during washing and drying, leave the fabric behind each circle.

6 inch circles

7. To perfectly center the 6 inch circle, place the 8 inch [View & Do Circle Shape](#) on top of the 8 inch fabric circle, making sure it is lined up accurately.
8. Center the 6 inch circle by placing it inside the opening of the 8 inch [View & Do Circle Shape](#).
9. Remove the [View & Do Circle Shape](#). Pin or use a spray adhesive to temporarily bond the circle to the square.
10. Topstitch around the outside edge of the fabric circle.
11. Trim the fabric behind the circle, if desired.

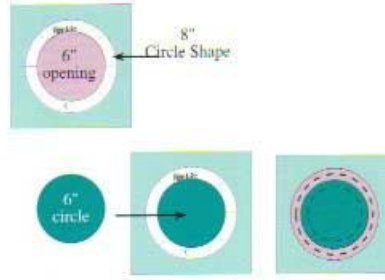

4 inch circles

12. To perfectly center the 4 inch circle, place the 6 inch [View & Do Circle Shape](#) on top of the 6 inch fabric circle, making sure it is lined up accurately.
13. Center the 4 inch circle by placing it inside the opening of the 6 inch [View & Do Circle Shape](#).
14. Remove the [View & Do Circle Shape](#). Pin or use a spray adhesive to temporarily bond the circle to the square.
15. Topstitch around the outside edge of the fabric circle.
16. Trim the fabric behind the circle, if desired.
17. With the right side up, press the bull's-eye.

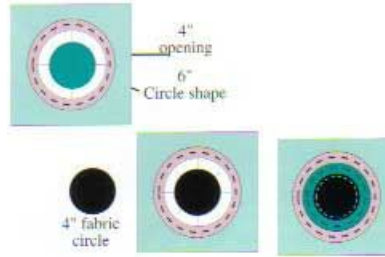

The bull's-eyes can be sewn together into a quilt, or they can be cut in halves or quarters.

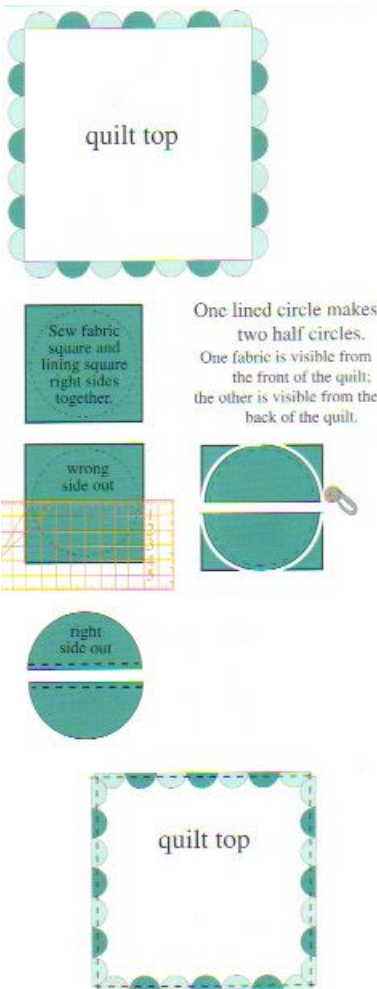
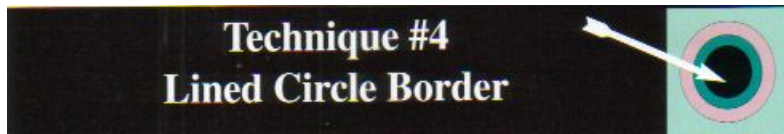

Lined Circles make an interesting edging for any quilt.

What size circles would look best on your quilt?

8 inches, 6 inches, or 4 inches.

Measure one side of your quilt. To get the number of half circles needed for each side, divide the side measurement by 4, 6, or 8.

1. Cut 8, 6, or 4 inch circles.

8 inch - cut 8-1/2 inch squares for both circle and lining.

On the wrong side of the lining, draw around the outside of the 8 inch [View & Do Circle Shape](#). This will be the stitching line.

6 inch - cut 6-1/2 inch squares for both circle and lining.

On the wrong side of the lining, draw around the outside of the 6 inch [View & Do Circle Shape](#). This will be the stitching line.

4 inch - cut 4-1/2 inch squares for both circle and lining.

On the wrong side of the lining, draw around the outside of the 4 inch [View & Do Circle Shape](#). This will be the stitching line.

2. Sew a circle square and a lining square, right sides together following the stitching line.

Cut the squares in half. Trim the corners of the squares 1/4 inch outside the stitching line. Turn half circles right sides out. Press.

Sew along the open edge, wrong sides together, using less than 1/4 inch seam allowance.

3. Space the half circles evenly along the side of the quilt, starting and ending 3/8 inch from each edge of the quilt. Pin and stitch the flat side of the half circles to the edge of the quilt top. The half circles can overlap slightly to get the circles to fit.

Press the seam allowances toward the quilt. Sew the backing and batting to the quilt top using an envelope style finish.

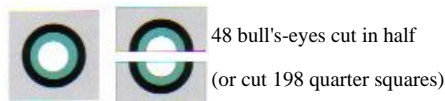

To line up the rows, there has to be a seam between each quarter square. Quarters can be cut, but an easier way to do this is to sew this seam to fold the half bull's-eye.

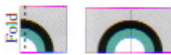

Fold the half bull's-eye in half, right sides together. Stitch 1/4" from the fold. Press



Sew into vertical rows. Add 6 inch squares to one end of each row.

Let's Finish the *Circle Bull's-eyes* Quilts

Borders

Cut the top and bottom border strips the width of the quilt. Pin the strip to the quilt at the center and end points. Sew from edge to edge of the quilt. Press the seam allowances toward the border strip.

Cut the side border strips the length of the quilt. Pin the strip to the quilt at the center and end points. Sew from edge to edge of the quilt. Press seam allowances toward the border strip.

Layer the Quilt

To layer a quilt means to stack 3 layers (top, batting, and backing) together.

Cut the backing and batting approximately 4 inches larger than the finished top. The backing of the quilt should be held taut by using a quilt frame or by taping the fabric, right side down, to a flat surface, such as the floor or a pingpong table. The batting is laid on top of the backing; smooth the batting out but don't stretch it. The quilt top is placed right side up over the batting.

Hand baste, safety pin baste or use Sulky KK2000 spray adhesive to hold the layers together.

Envelope Style Finish

Sew the top and backing right sides together with the batting underneath. Leave an 8-10 inch opening to turn right side out.

Binding

A binding finishes off the edges and frames the quilt.

Cut the binding strip 1-3/4 inches wide. Press a diagonal crease in the start of the binding strip. Fold the binding strip in half, wrong sides together, and press.

Sew, using 1/4 inch seam allowance, the raw edges of the binding strip even with the edge of the quilt top.

Leave a 6 inch tail at the beginning of the binding and start sewing on one side of the quilt - never at the corner. Sew with both raw edges of the binding even with the edge of the quilt.

To Perfect Miter the corners:

Step 1: Sew to 1/4 inch from the next side of the quilt. With the needle in the quilt, pivot and sew diagonally to the corner of the quilt. This forms a sewn-in-miter.

Step 2: Fold the binding strip up so it lines up with the next side of the quilt.

Step 3: Bring the binding strip down even with the next side. Start stitching from the edge of the quilt. Sew to the next corner.

After mitering the last corner, lay the beginning and ending of the strip together. Where the two ends meet, fold and crease the end of the strip on the diagonal. Bring the folded crease lines right sides together, pin and sew. Finish sewing the binding to the quilt.

Sew the binding strip to the wrong side of the quilt by hand, mitering the corners.

Mitered Corners

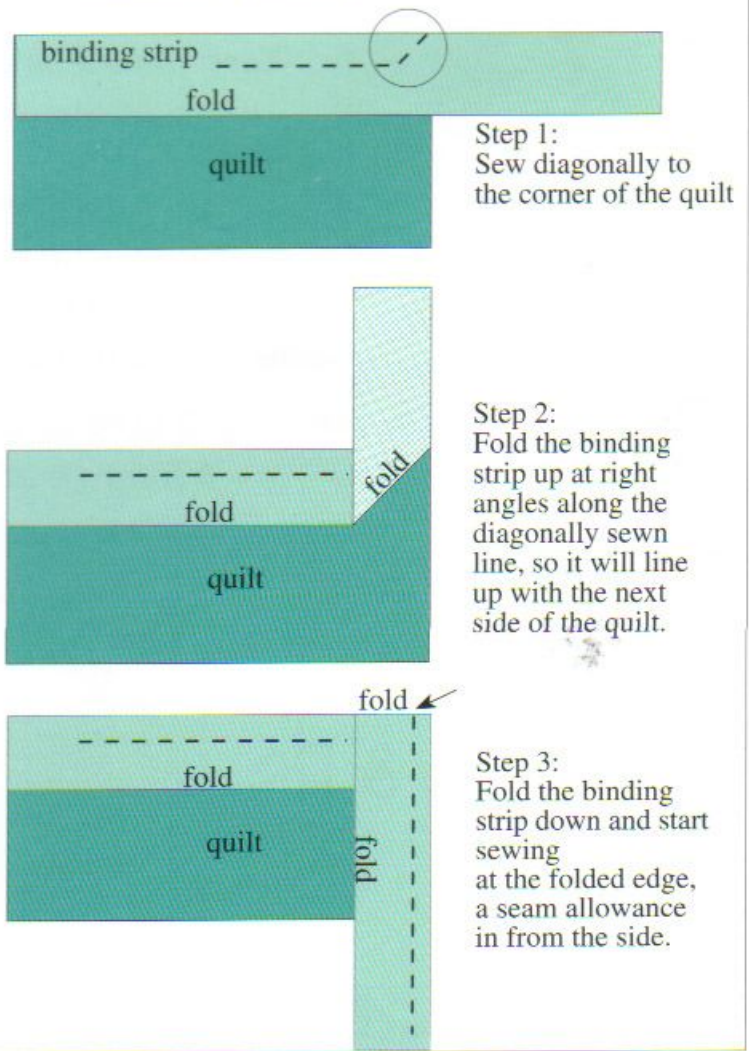

Copyright 2002, Kaye Wood, Inc

<http://www.kayewood.com>